

PR-DM30

Ultra Small Diffuse Reflection Photoelectric Sensor



- Small size, save space.
- Easy to install, using standard M3 screws.
- A unique stable detection algorithm is adopted.
- Waterproof characteristics of stainless steel SUS316L shell.
- With metal shell, it can be used in high humidity environment of water or other liquids.



Technical Specifications

Power Source Voltage	12-24VDC±10%including a ripple
Current Consumption	19mA
Control Output	PNP/NPN Open collector 50mA/24V or less Load Current : 50mA or less, Residual Voltage : 2.5V or less
Sensing Distance	2-30mm
Response Time	Max. 1ms
Output Method	Light ON / Dark ON Selectable output
Light Source	Red LED (650nm)
Spot Diameter	Ø7mm (The distance at 30mm)
Indicator Light / Display	Out: Red / Stable operation: Green
Operating Temperature / Humidity	-10~+50C° / 35~85%RH (No freezing and No condensation)
Storage Temperature / Humidity	-10~+60C° / 35~85%RH (No freezing and No condensation)
Vibration Resistance	10~55Hz Amplitude 1.5mm 2 hours for each direction of X,Y and Z
Shock Resistance	500 m/s ² , each 3 times for X/Y/Z axis
Circuit Protection	Reverse electrode protection, Short-circuit protection
Protective Category	IP67
Material	SUS316L Stainless Steel
Connection Type	2m Cable

Dimensions

*Unit : mm

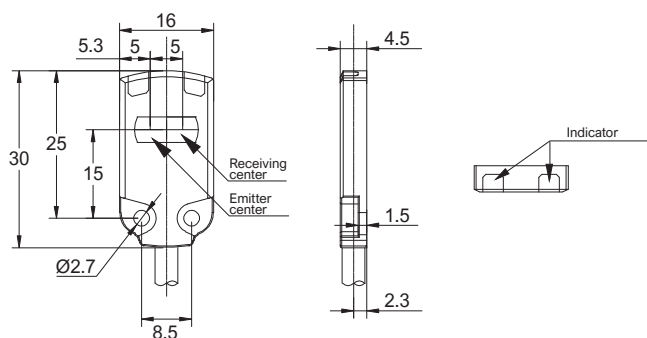

Model Selection

PR-DM30P	PNP
PR-DM30N	NPN