

# raxoll

## PR-CMS11 Series

### Color & Mark Sensor



raxoll.com

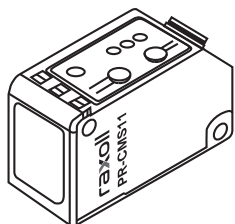

## INSTRUCTION MANUAL

Thank you for choosing raxoll color&mark sensor. Please read the manual before using this product.

- The product should be applied by someone with a certain level of electrical knowledge.
- Please read and make sure that you understand how to operate the product before using it.
- Please keep this manual readily accessible for future reference when needed.

### WARNING



Please do not exceed maximum rated voltage during usage in order to prevent tester malfunction or fire.



Please do not apply AC power supply to avoid breakage.



Please do not subject the product to high temperature to avoid scalding.

### SAFETY PRECAUTIONS

It is dangerous to wire or attach/remove the connector with the power on. Make sure to turn off the power before operation. Make sure to use the product with the protective cover attached and closed.

Installing in the following places may result in malfunction:

1. A dusty or steamy place.
2. A place generating corrosive gas.
3. A place directly receiving scattering water or oil.
4. A place suffered from heavy vibration or impact.

The product is not designed for outdoor use.

Do not use the sensor in transient state after power on (approx. 300ms.)

Do not wire with the high voltage cable or the power line.

Failure to do this will cause malfunction by induction or damage.

The sensor performance or digital display values may depend on the individual units or the condition of detected product.

This product is not an explosion-proof construction.

Do not use the product under flammable, explosive gas or liquid environment.

Do not use the product in water.

Do not disassemble, repair or convert the product.

Failure to do this may cause failure, fire or electric shock.

Operate within the rated range.

### ACCESSORIES LIST



1 PCS INSTRUCTION MANUAL

## TECHNICAL SPECIFICATIONS

Model	PNP PR-CMS11P	NPN PR-CMS11N
Detection Distance	Light point size 1.5*7mm (23mm detection distance)	
Power	24VDC + 10% pulsation less than P.P10%	
Current Consumption	Power less than 850mW (power voltage is 24V, the current consumption is below 35mA).	
Mode Switching Input	Light Intensity Mode	Low (OFF) 0 to 0.8VDC Outflow current below 5mA Input impedance about 10kΩ
	Color Mode	High (ON) 12 to +VDC or open High (ON) 12 to +VDC Outflow current below 3mA Input impedance about 10kΩ
Output	NPN Open circuit collector transistor *Maximum inflow current: 50mA *Applied voltage below 30VDC (between output and 0V) *Residual voltage below 1.5V (when current 50mA)	PNP Open circuit collector transistor *Maximum inflow current: 50mA *Applied voltage below 30VDC (between output and +V) *Residual voltage below 1.5V (when current 50mA)
	Light Intensity Mode	Light intensity output ON
Output Control	Color Mode	Color matching ON
	Short Circuit Protection	Equipped (automatic recovery)
Ambient Temperature	-10 to +55°C (no exposed, no freezing) save: +20 to +70°C	
Ambient Humidity	35 to 85%RH save: 35 to 85%RH	
Optical Element	Red / Green / Blue composite LED (Wave peak/wavelength: 640nm / 525nm / 470nm)	
Material	Case: PBT - Operation Panel: PC - Operation Button: Silica - Gel Lens: PC	
Cable	0.2mm 4 core rubber cable standard 2m Distinction (color matching) Brown: +V - Black: Output - Pink: Mode Conversion Input - Blue: 0V	
Weight	About 110g	

\* Specified Measurement Conditions: Ambient Temperature +23°C

## INDICATOR / BUTTONS

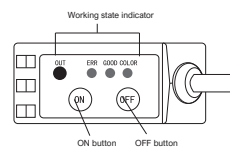

## OUTPUT CIRCUIT DIAGRAM

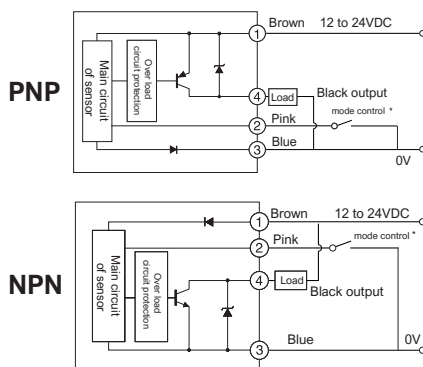

### NOTE

When the pink line break (OFF) is for the color mode,  
When the pink line is connection (ON) is for the light intensity mode.

## DIMENSIONS

\*Unit : mm

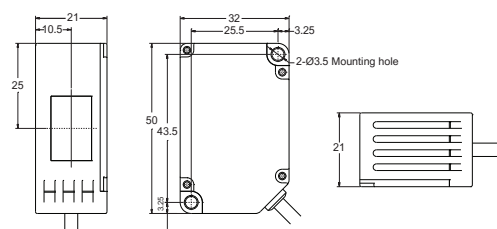

## INSTALLATION

For detecting the moving direction of the object, please pay attention to the installation direction of the sensor. The fastening torque should be below 0.8N.m.

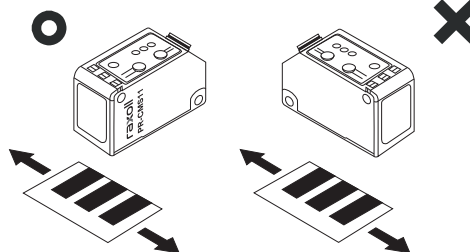

### NOTE

Do not use sensors to detect objects in this direction. This may lead to irregular work.

## SETTING METHOD

Before setting up the instruction, confirm the light intensity mode or the color mode. The "COLOR" green indicator is always bright is color mode and extinguished as a color intensity mode.

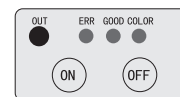

### Two point setting method

- ① When the projection light of the sensor against the measured color, presses the "ON" button, and the "GOOD" green indicator lights flicker.
- ② When the projection light of the sensor against the background color, presses the "OFF" button.
- ③ When the threshold value set between steps ① and ② is stable, the "GOOD" green indicator light is always bright, indicating that it can start normal detection. When the threshold value set between steps ① and ② is not stable, the "ERR" red indicator flashes for 3 seconds and revert to the last set state.
- ④ If you want to switch NO (normally open) to NC (normally closed) output mode, you need to change the order of steps ① and ②.

### Threshold value adjustment

- ① Press the "ON" button for more than 5 seconds until ERR, GOOD and COLOR three indicators flicker simultaneously.
- ② Press the "OFF" button to adjust the threshold value.

The relationship between the return difference state and the light flicker is as follows:

State	Indicator	Three indicator flicker
Return difference value small	○ ○ ○	only the color indicator flicker
Return difference value medium	○ ● ●	GOOD, COLOR indicator flicker together
Return difference value large	● ● ●	ERR, GOOD, COLOR 3 indicator flicker together

### Threshold value adjustment

Exit threshold value adjustment

Under the condition of threshold adjustment, press the "ON" button for more than 5 seconds until the three lights of ERR, GOOD, and COLOR stop flashing, that is, the threshold return adjustment is withdrawn.

### About false information hints

Indicator light state	The "ERR" red indicator is always lit and will not be extinguished automatically.
Error information content	The output line load is short circuited, and the overcurrent goes through.
Handle	After turn off the power supply, check the output line load.

## YOU CAN NOTE HERE

## CONTACT US

✉ info@raxoll.com  
✉ +90 (232) 457 22 84

# raxoll



raxoll.com

PEAK OTOMASYON ELEKTRİK MAKİNA  
İC VE DİS TİC. LTD. STİ.

Halkapınar Mh. 1376 Sk. No:1/R  
Konak/İZMİR