

### PR-BG30

BGS Laser Photoelectric Sensor



- Laser light source, small spot to achieve accurate detection of small objects.
- With BGS function, the detection is not affected by workpiece material and background color.
- Strong anti-interference and stability.



### Technical Specifications

Power Source Voltage	12-24VDC±10%including a ripple
Current Consumption	Max. 30mA
Control Output	PNP/NPN Open controller transistor, Maximum load current: 100mA Residual voltage: 2V or less(At 100mA load current) Residual voltage: 1V or less(At 10mA load current)
Response Time	Max. 0.5ms
Hysteresis	Less than 3%
Sensing Range	40 ~ 300mm
Output Method	Light ON / Dark ON Selectable output
Light Source	Laser (650nm) , JIS/IEC CLASS1, FDA CLASS I Max. 4.5mW
Spot Diameter	Ø1mm (The distance at 300mm)
Indicator Light / Display	Out: Red / Power: Green
Range Setting Regulator	5-turn knob adjuster
Operating Temperature / Humidity	-10~+50C° / 35~85%RH (No freezing and No condensation)
Storage Temperature / Humidity	-20~+60C° / 35~85%RH (No freezing and No condensation)
Vibration Resistance	10~55Hz Amplitude 1.5mm 2 hours for each direction of X,Y and Z
Shock Resistance	500 m/s <sup>2</sup> , each 3 times for X/Y/Z axis
Circuit Protection	Reverse electrode protection, Short-circuit protection
Protective Category	IEC60523: IP67
Material	PC
Connection Type	2m Cable

### Dimensions

\*Unit : mm

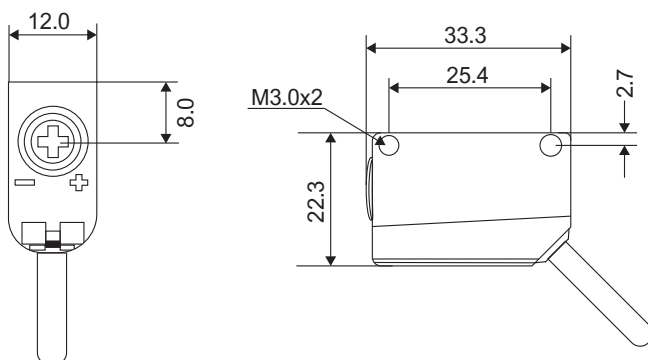

### Model Selection

PR-BG30P	PNP
PR-BG30N	NPN